

GENERAL TERMS & CONDITIONS

- 1** Retail outlets will setup at premises of PRTC, where lands belonging to PRTC are available in the State of Punjab.
- 2** PRTC will provide the exact location of various PRTC premises building roads having good traffic/ vehicular movement for setting up of retail outlets.
- 3** PRTC will provide necessary place/ area for installing the "Retail Outlets" based on the dimensions mutually agreed between the firm/ company.
- 4** All the statutory clearances/ licenses and NOC to enable to install retail outlet shall be obtain by the firm/ company at his own level.
- 5** There will be separate lease agreement for specific site and the terms and conditions of lease agreement shall bind the company/ firms.
- 6** The firms/ companies will submit their proposal in different modes i.e. CODO Model (Company owned dealer operated), COCO Model (Company owned Company operated) and Lease basis. The best suited and profitable mode will be selected by the PRTC.
- 7 Eligibility Criteria**
The interested Agencies/ Firms shall have the requisite know how/ expertise in the relevant field for setup retail outlets (Ros) throughout the country to market petroleum product to the general public and other value added services to the customers.
- 8 Settlement of disputes**
The dispute and difference arising in any concerning agencies/ firms what so ever shall be referred to sole Arbitrated i.e. Managing Director PRTC.
- 9** The courts at Patiala alone shall have Jurisdiction for the purpose of this contract.
- 10** The Managing Director PRTC reserves the rights to accept or reject proposal at any stage without assigning any reason.



PEPSU ROAD TRANSPORT CORPORATION PATIALA



GENERAL REQUIREMENTS

PRTC intends to offer spaces/ sites for setting up of retail petroleum outlets on the following premises of PRTC:-

Sr. No.	Premises of PRTC	District	Area in acre	Layout Plan
1	PRTC Head Office Nabha Road Patiala	Patiala	8.45	Annexure-A
2	PRTC Workshop Sirhindi Gate Patiala	Patiala	3.83	Annexure-B
3	PRTC Old Bus Stand Patiala	Patiala	4.32	Annexure-C
4	PRTC Workshop Sangrur	Sangrur	3.00	Annexure-D
5	PRTC Bus Stand Patran	Patiala	2.50	Annexure-E
6	PRTC Sub Depot Daula	Bathinda	1.67	Annexure-F

1 The offer should be submitted in a two bid system:-

A Technical Bid

Technical Bid should be place in separate envelope and marked as 'Technical Bid'

B Financial Bid

The Financial Bid should be placed in separate envelope and marked as 'Financial Bid'

Both the Technical and Financial Bid envelop should be sealed separately and then put in a third envelop and sealed duly superscripted as OFFER FOR LAND AT "Name of location"

2 The last date for submit their EOI in the office i.e. PRTC Head Office, Nabha Road Patiala is 09.04.2025 upto 5:00 pm.

3 Any type of information/ clarification/ corrigendum and addendum regarding EOI can be seen on PRTC website www.pepsurtc.com

WORKSHOP I & II PATIALA

TO RAJPURA

PATIALA - RAJPURA ROAD

TO BUS STAND PATIALA

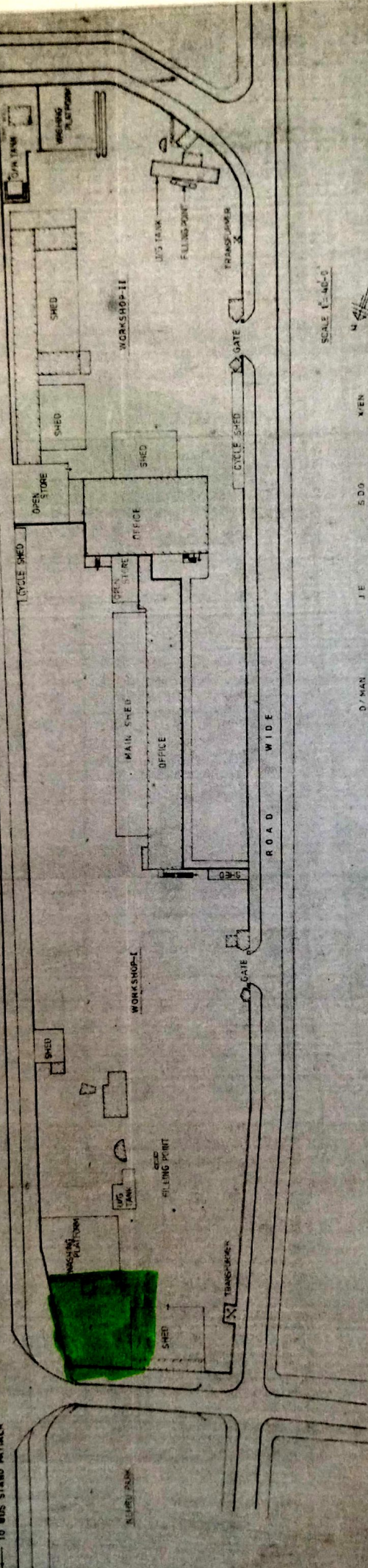

SCALE 1" = 40'-0"

0' MAN J E 500 XEN

Annexure
B

Proposed
Site

Workshop Sanghul

Annexure 'D'

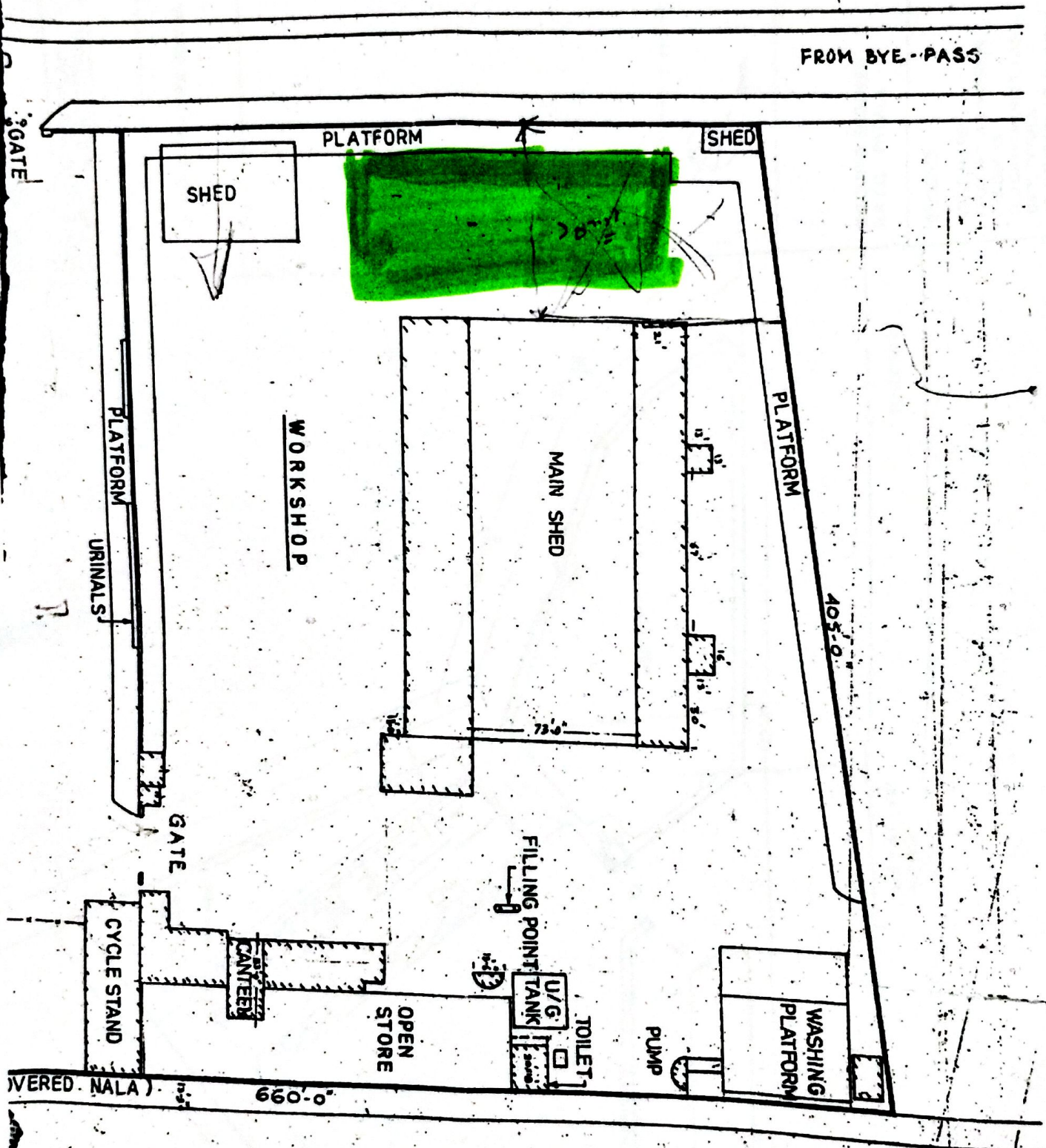

proposed site

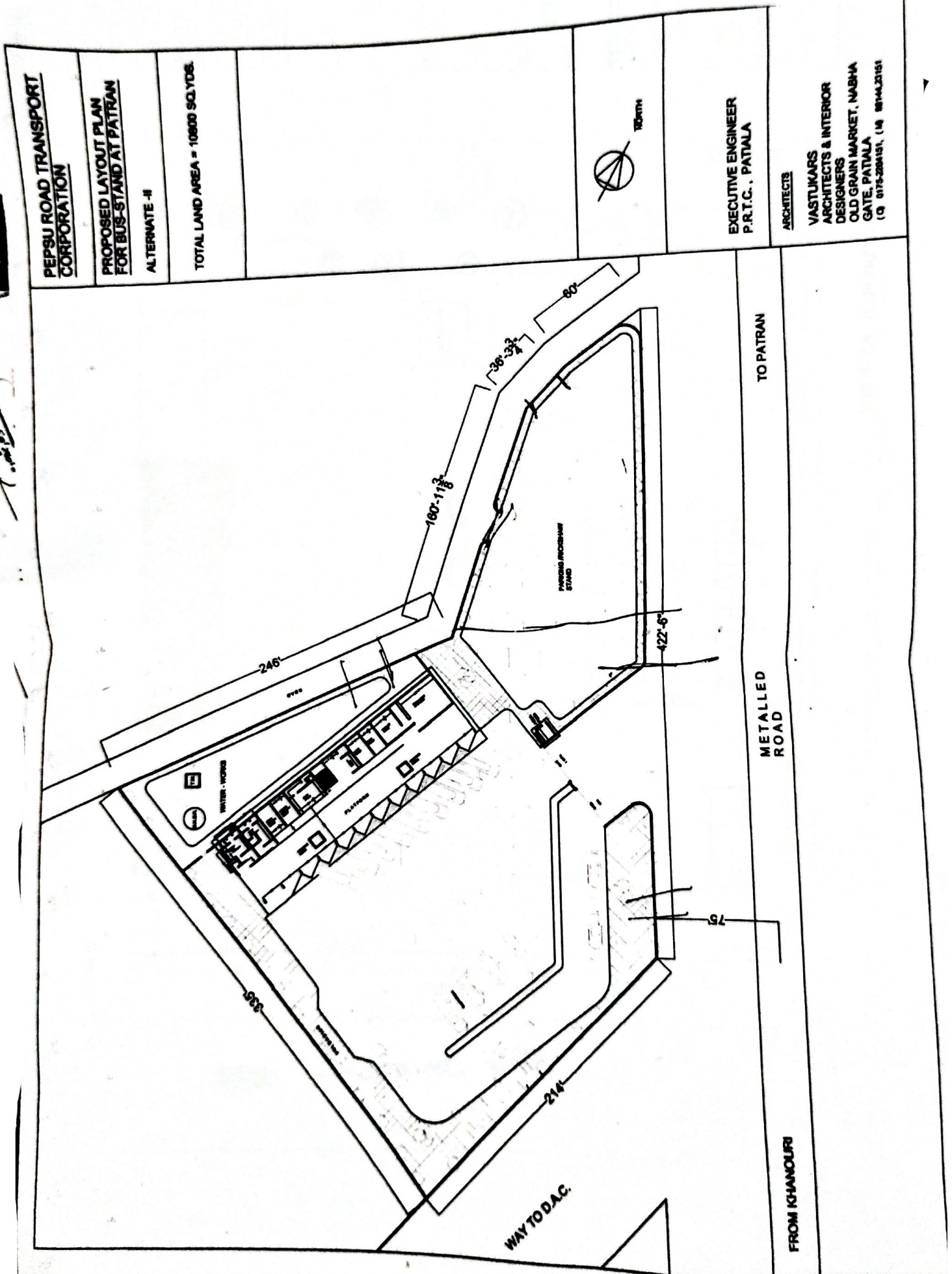

Annexure-F

GENERAL NOTES

1. The drawings and design are the intellectual property of BHA. They may not be reproduced, copied, circulated or used for any other purpose without the written consent of BHA.
2. The drawings are to be used in conjunction with the relevant specifications and conditions of contract.
3. All dimensions are in meters unless otherwise stated.
4. The drawings are prepared and signed for the satisfaction of the client and the relevant authorities.
5. Any and all information in this drawing is subject to change without notice.
6. The drawings are prepared in accordance with the relevant specifications and conditions of contract.
7. All levels indicated on this drawing are based on the datum of 257.00.
8. The drawings are to be used in conjunction with all other drawings and specifications.
9. The drawings are to be used in conjunction with all other drawings and specifications.
10. The drawings are to be used in conjunction with all other drawings and specifications.
11. The drawings are to be used in conjunction with all other drawings and specifications.
12. The drawings are to be used in conjunction with all other drawings and specifications.
13. The drawings are to be used in conjunction with all other drawings and specifications.
14. The drawings are to be used in conjunction with all other drawings and specifications.
15. The drawings are to be used in conjunction with all other drawings and specifications.
16. The drawings are to be used in conjunction with all other drawings and specifications.
17. The drawings are to be used in conjunction with all other drawings and specifications.
18. The drawings are to be used in conjunction with all other drawings and specifications.
19. The drawings are to be used in conjunction with all other drawings and specifications.
20. The drawings are to be used in conjunction with all other drawings and specifications.

SPECIFIC NOTES

NO.	REVISION	DATE
1		
2		
3		
4		
5		
6		
7		
8		
9		
10		
11		
12		
13		
14		
15		
16		
17		
18		
19		
20		

PROJECT: WORKSHOP AT GIDERBAHA

PROJECT TEAM:

ARCHITECT: BHA ASSOCIATES
ARCHITECTS: BHA ASSOCIATES
STRUCTURAL ENGINEER: BHA ASSOCIATES
MECHANICAL ENGINEER: BHA ASSOCIATES
ELECTRICAL ENGINEER: BHA ASSOCIATES
LANDSCAPE ARCHITECT: BHA ASSOCIATES

STRUCTURAL ENGINEER CONSULTANT

LANDSCAPE CONSULTANT

CLIENT

PRTC

DRAWING TITLE

SITE PLAN

DRAWING NO.

A-01

REVISION BY

R2

SCALE

DATE

CHECKED BY

DATE

BY BHA ASSOCIATES

NTS

FIG. 302

A. BHA ASSOCIATES

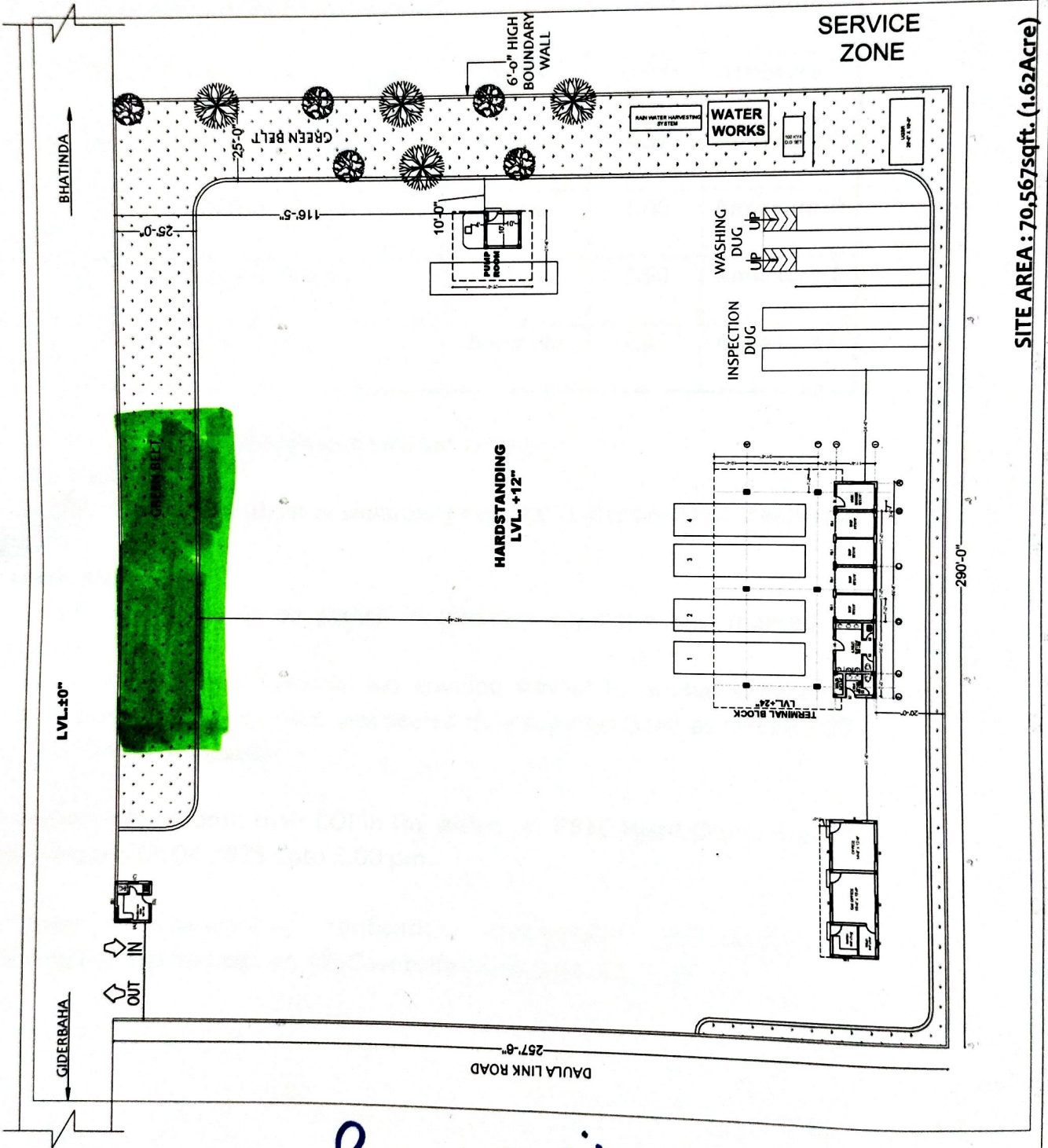

SITE AREA: 70,567sqft. (1.62Acre)

Proposed site